

# Roeland Park Aquatic Center Project Update June 17, 2019



# Updated First Phase Layout and Costs





# First Phase Layout

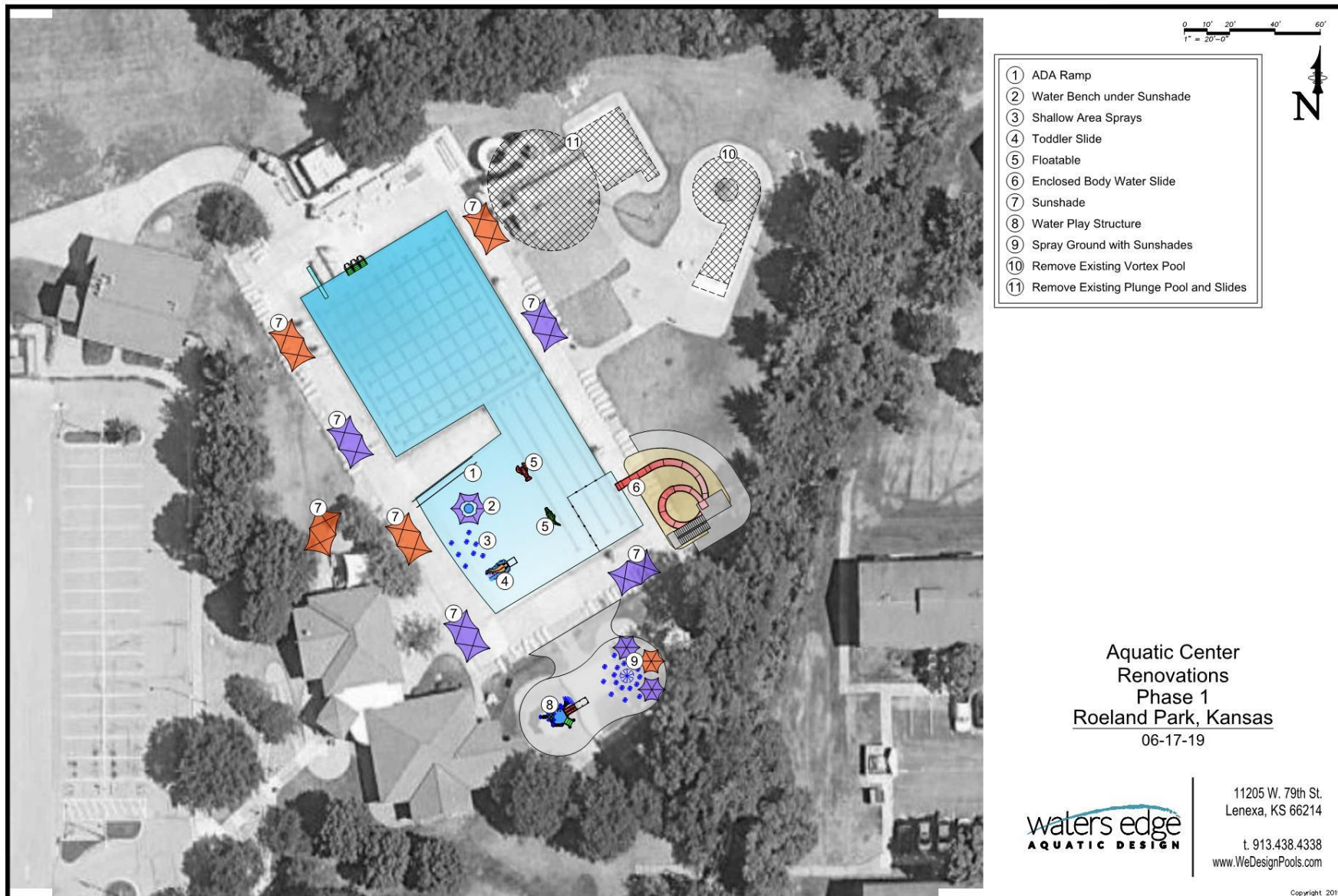

# First Phase Layout



Project Cost  
\$1.64 million

## Example Phased Option

### Project Costs

Base project includes security lights, shade, toddler slide, ADA ramp, sprays and shade in pool, demo for slides and vortex pool

- Base project \$1.38 million
- Base + floats + lights + family \$1.43 million
- **Base + floats + lights + tube slide \$1.64 million**
- Base + floats + lights + family + tube + bridge \$1.84 million
- Base + floats + lights + family + tube + bridge + speed \$2.12 million
- Base + floats + lights + family + tube + bridge + speed + river \$3.04 million

For your consideration:

- Construction costs are basically contractor bid costs.
- Project costs include contractor costs plus fees and a contingency.
- Sequence of construction requires planning buried items first.
- Provided costs do not include inflation.
- Inflation cost increases will continue annually for labor and materials.



An aerial photograph of a large outdoor swimming pool complex. The main pool is rectangular with multiple lanes marked by dark blue lines. To the left of the main pool is a smaller pool with a white, winding water slide. The pool is surrounded by a concrete deck with lounge chairs and some trees. A dark blue banner is at the top, and a semi-transparent white banner is at the bottom.

**Thank you**

**Comments**



# Pool Renovation with Full Options

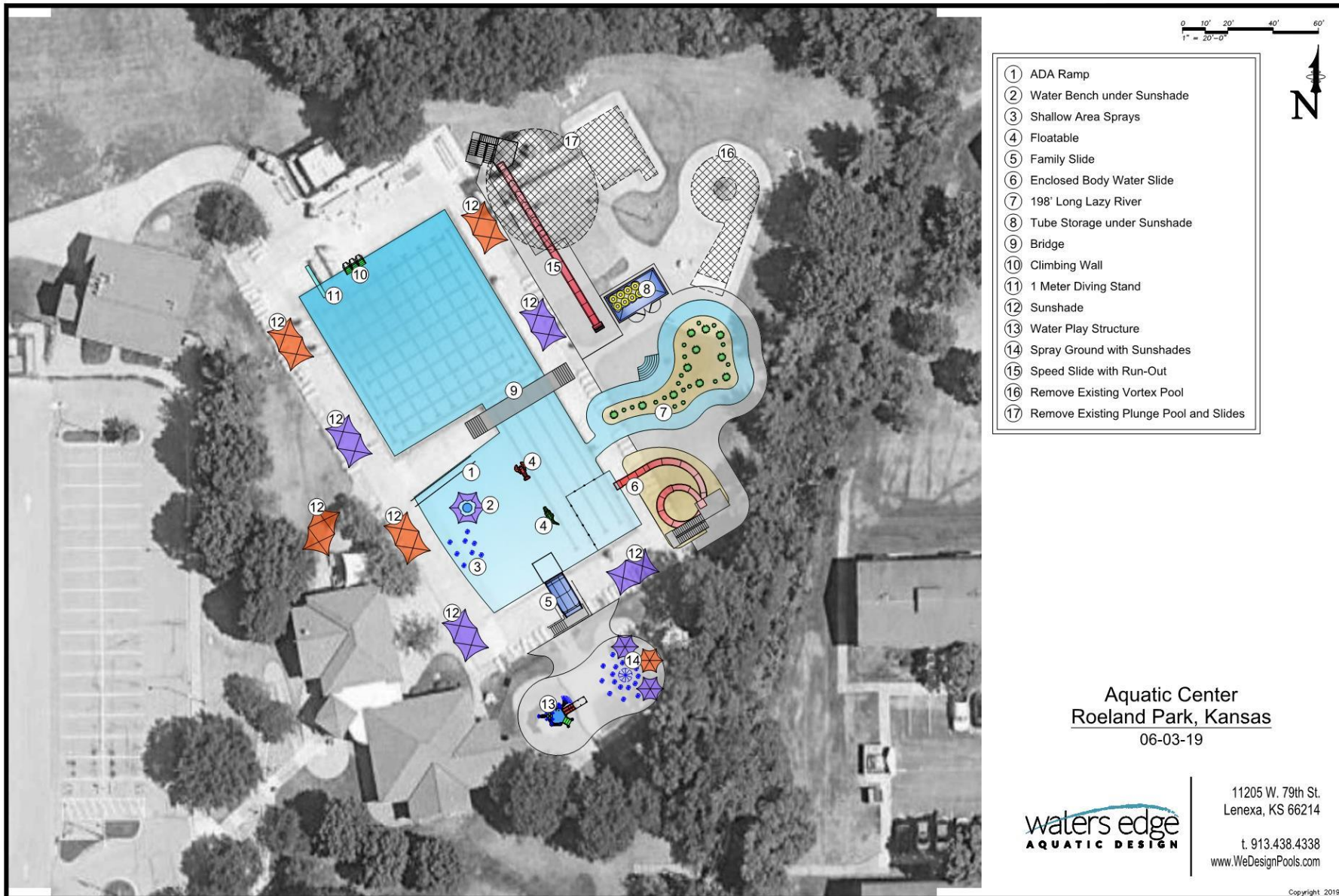



## Project Costs for Options

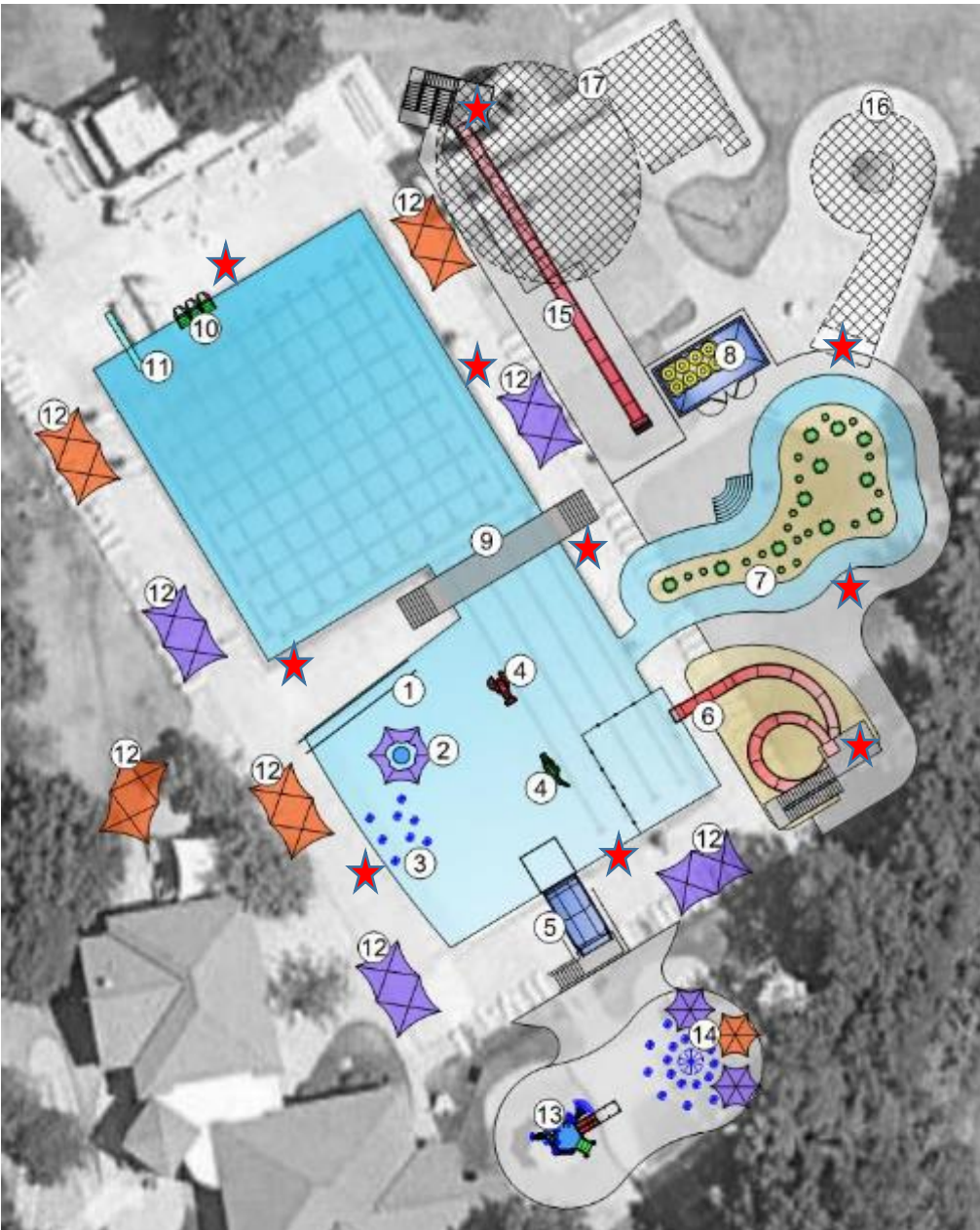

### Project Costs

- Floatables \$ 20,000
- Full night lighting \$ 55,000
- Family slide \$135,000
- Bridge \$120,000 for wood  
\$200,000 for concrete
- Tube slide \$235,000
- Speed slide \$355,000
- Lazy river \$875,000
- ★ Lifeguards shown on layout (10 – 12)

### Project Costs

Base project includes security lights, shade, toddler slide, ADA ramp, sprays and shade in pool, new spray area and play structure, and demo for slides and vortex pool

- Base project \$1,380,000
- Bridge \$120,000 to \$200,000
- Family slide \$135,000
- Tube slide \$235,000
- Speed slide \$355,000
- Lazy river \$875,000